

2" black iron piping for fill and vent. Install fast fill cap on fill.
install two, 10"x10" louvered panels with 1/4" mesh screen. One within 12" of ceiling, the other within 12" of floor.
see sheet M3 for additional mechanical room details
6'-0"
2 hour rated fire door with automatic closing device

MANIFOLD A	CIRCUIT NAME:	CIRCUIT LENGTH:
	Office / conference:	428+10=438 ft.
	Kitchen / bath:	406+10=416 ft.
	Records storage:	453+10=463 ft.
	Bookkeeper / Super:	318+10=328 ft.
	Town clerk's office:	440+10=450 ft.
	Foyer #1:	299+10=309 ft.
	Foyer #2:	238+10=248 ft.
	Community rm.(outer):	283+10=293 ft.
	Community rm.(middle):	352+10=362 ft.
	Community rm.(inner):	353+10=363 ft.
	Court room (outer):	282+10=292 ft.
	Court room (middle):	286+10=296 ft.
	Court room (inner):	260+10=270 ft.
	Holding room:	232+10=242 ft.
	Justice / court clerk:	289+10=299 ft.
	Assessor's office:	457+10=467 ft.
	Codes office (outer):	289+10=299 ft.
	Codes office (inner):	254+10=264 ft.

MANIFOLD B

All tubing shall be Weil-McLain 5/8" AlumiPex tubing
All lengths include 10 ft. allowance for risers to manifold
TOTAL TUBING = 6099 FEET.

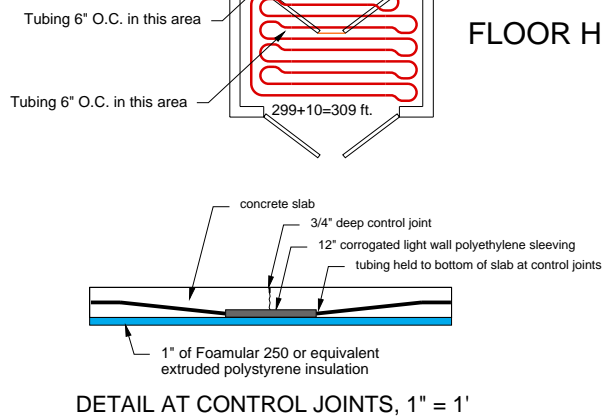

FLOOR HEATING TUBING CIRCUITS, 1/4" = 1'

- NOTES:
1. All floor heating tubing shall be 5/8" PEX-AL-PEX tubing.
 2. All tubing shall be secured to welded wire fabric reinforcing at intervals not exceeding 30" using wire twist ties.
 3. All underslab areas shall be insulated with 1" of Foamular 250 or equivalent 25 psi rated extruded polystyrene insulation.
 4. Tubing and mesh shall be lifted during pour to approximately 1/2 the thickness of slab other than at control joints.
 5. Verify that manifold stations are installed with access from directions indicated.
 6. All tubing shall be sleeved at control joint crossings as shown on detail.
 7. All circuits shall be pressured tested to 75 psi air pressure for minimum of 24 hours prior to concrete pour.
 8. Maintain tubing a minimum of 9" away from all closet flanges and drain traps.
 9. Verify flow direction all all circuits (indicated by arrows) when connecting to manifolds
 10. See sheet M4 for associated thermostat wiring